



**Kawasaki Z1000  
Fender Eliminator Kit  
P/N: 670-4830, 675-4830**

Kit Contents

Part Number	Description	Quantity	Part Number	Description	Quantity
99-FE-670-4830	Fender Brackets	2	Locknuts	6mm Locknut	6
99-HB-6x20	BH 6x20 Bolt	4	99-Wash6x15	6x15mm Washer	10
99-HB-6x12	BH 6x12 Bolt	2	99-Wash6x12	6x12mm Washer	2

1. Remove Rider and Passenger Seat
2. Remove the tail section bodywork. The bodywork is snapped and slide into place, be careful not to damage the body work while removing.



3. Remove the four bolts (circled in red) holding the plastic wire harness cover in place. Remove the cover.



4. Remove the turn signal housing that holds the turn signal connectors in place. Identify and mark the left and right hand turn signals. Disconnect the turn signal and plate light connections.



5. Remove the fender by removing the four fender button head bolts and the two philip head screws holding the fender in place. Guide the wires through the center hole.



6. Mount the DMP base plate using two 6x1.0x20 bolts, four 6x15 (larger) washers and two 6x1.0 lock nuts.

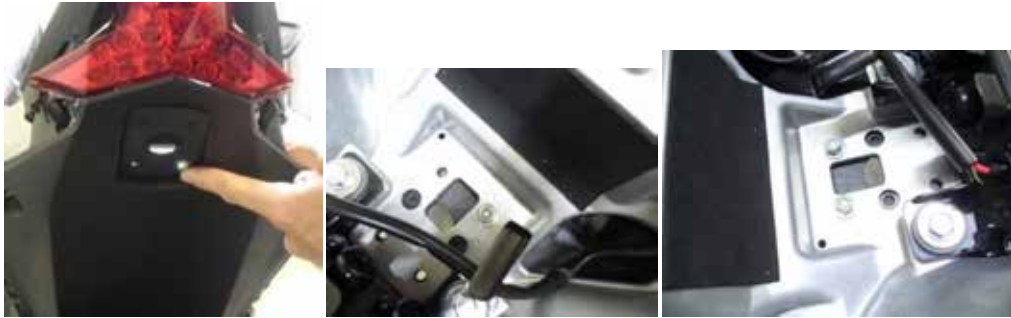

7. Mount the DMP Plate Bracket using two 6x1.0x20 bolts, four 6x15 (larger) washers and two 6x1.0 lock nuts.



Step 8 is for 675-4830

8. Mount the 900-0070 marker lights to the DMP plate. Plug in the DMP OEM wire connectors (900-0121) and wire extenders (900-0124). Plug the turn signal wires into the correctly identified left and right turn signal wire extenders. Make sure to do one turn signal at a time. Install and wire DMP plate lights with included connectors.



9. Repeat steps 3-1 to complete install.

670-4830



675-4830

