



**Yamaha FZ07
Fender Eliminator Kit
P/N: 670-6410**

Kit Contents

Part Number	Description	Quantity	Part Number	Description	Quantity
99-FE-670-6410	Fender Brackets	1	Locknuts	6mm Locknut	6
99-HB-6x16	BH 6x16 Bolt	2	99-Wash6x15	6x15mm Washer	10
99-HB-6x12	BH 6x12 Bolt	8	99-Wash6x12	6x12mm Washer	6
428-9145	Spacer Large	2	428-9146	Spacer Small	1

1. Remove passenger seat
2. Remove the under tail rivets



3. Remove forward tail section screws.



4. Remove rear tail section screws and tail light bodywork cover. Slide the cover back toward the rear of the bike.

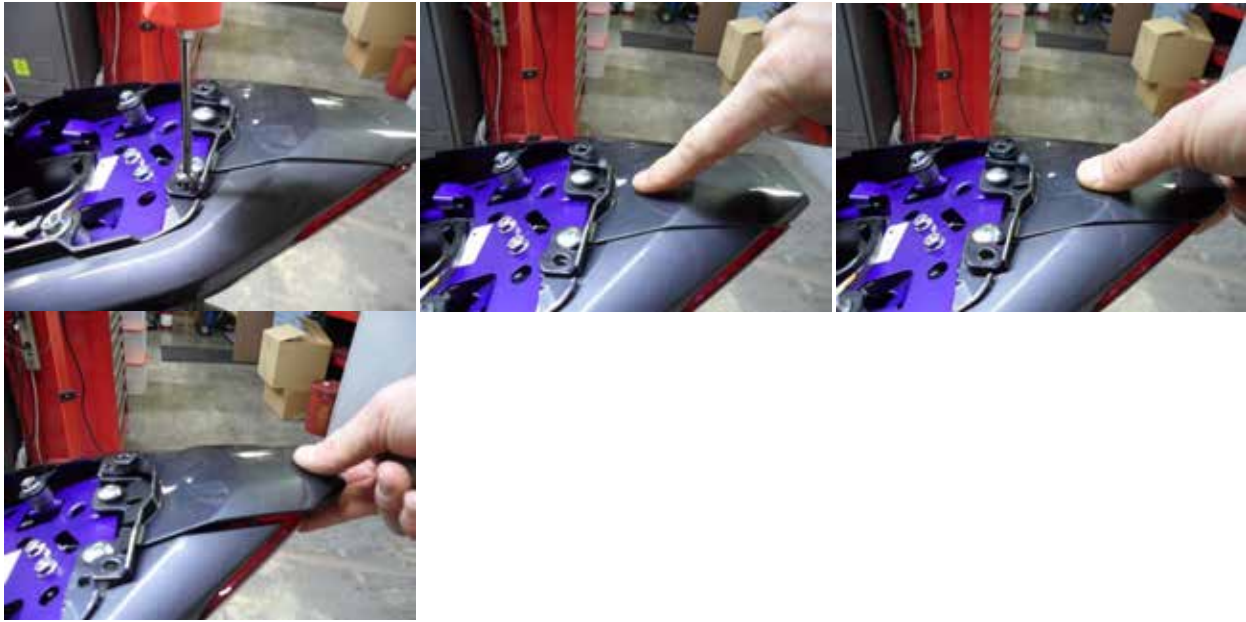

5. Remove the four tail section bolts.



6. Locate, cut and remove the wiring zip tie. Unsnap the wiring clamp.

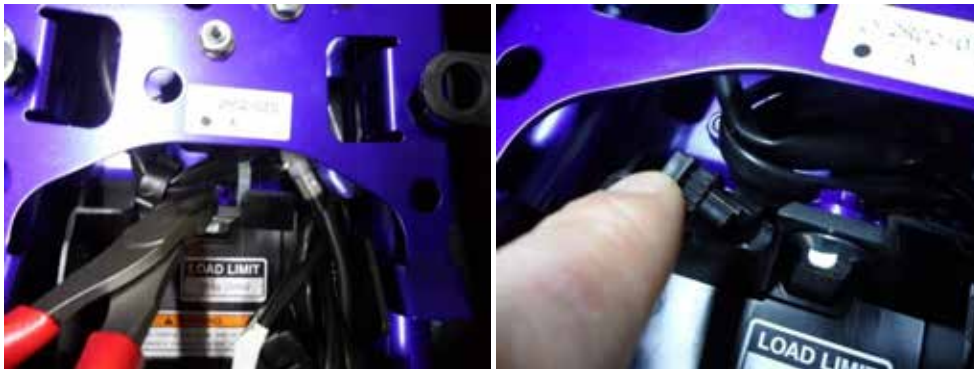

7. Locate the turn signal and plate light connections and unplug them. Make sure you identify and mark the left and right hand turn signals before unplugging them.

Moto911 Inc. - 1062 Calle Negocio, Ste. D San Clemente, Ca. 92673 – (949)453-9111

8. From underneath the tail section you can now access and remove the four bolts holding the stock fender in place. When removing the stock fender guide the turn signal and plate light wires through the center of the tail section. Do not force anything.



9. Remove and assemble the DMP Fender Eliminator as shown below. The two forward holes will use two 6x1.0x12 button head bolts, four 6x15 (larger) washers and two lock nuts. The rear holes will use two 6x1.0x16 (longer) button head bolts, four 6x12 (smaller) washers and two lock nuts. The rear holes will include the license plate bracket and require the bolts to be inserted into the top and the lock nuts will be used on the bottom.

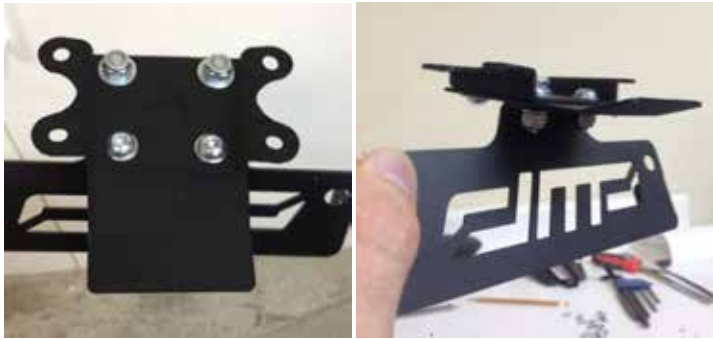

10. Bolt the assembled DMP Fender Kit to the bike using four 6x1.0x12 button bolts and four 6x15 (larger) washers. Make sure you use medium thread locker on each bolt.



11. Put the two forward body work rivets back into place.



12. There are three rivets left, two larger rivets and one smaller rivet. Apply the two larger supplied plastic spacers to the larger rivets and the smaller spacer to the smaller rivet. Press the rivets back into place as shown. This will allow for a clean look without having to worry about the rivets falling out of place.



STEP 13 IS FOR 675-6410 KITS WITH OEM CONNECTORS and TURN SIGNALS (pictures below are for reference only)

13. Install DMP OEM turn signal connectors and wire extenders by plugging them in. Install the DMP marker lights and plate lights to the DMP Fender Eliminator. Plug the marker lights into the previously identified DMP OEM turn signal connectors (left marker light plugs into left turn signal connector and vice versa). Cut and splice the previously identified plate light wires using the stock plate light wires (that you are removing) and supplied butt connectors. Re route the wires in the stock location. Make sure all connections are solid and no bare wires are showing. Insert and turn the key to check all signals.





14. Complete steps 3-6 in reverse for final install

670-6410



675-6410

