



**Kawasaki ZX10R  
Fender Eliminator Kit  
P/N: 680-4940  
MADE IN THE USA!**

Kit Contents

Part Number	Description	Quantity	Part Number	Description	Quantity
99-FE-680-4940	Fender Brackets	2	99-Wash6x12	6x12mm Washer	4
99-Wash6x15	6x15mm Washer	2	99-HB-6x12	6x12 Bolt	4
99-LN-6	6mm Locknut	4			

Note: To complete your installation we recommend using DMP Marker Lights and DMP OEM Type Wire Harness, which are available from your local DMPdealer or [www.moto911.com](http://www.moto911.com).

1. Remove rear seat.



2. Remove any contents in the storage compartment.





3. Remove rear cowling.



4. Remove rider seat.



5. Remove rear side panels. There are several plastic fasteners, simply push in the center to release. Pull center back out and push back in to install.





6. Remove under tail.



7. Unplug existing electronics.



8. Loosen exiting fasteners that hold on OEM rear fender.

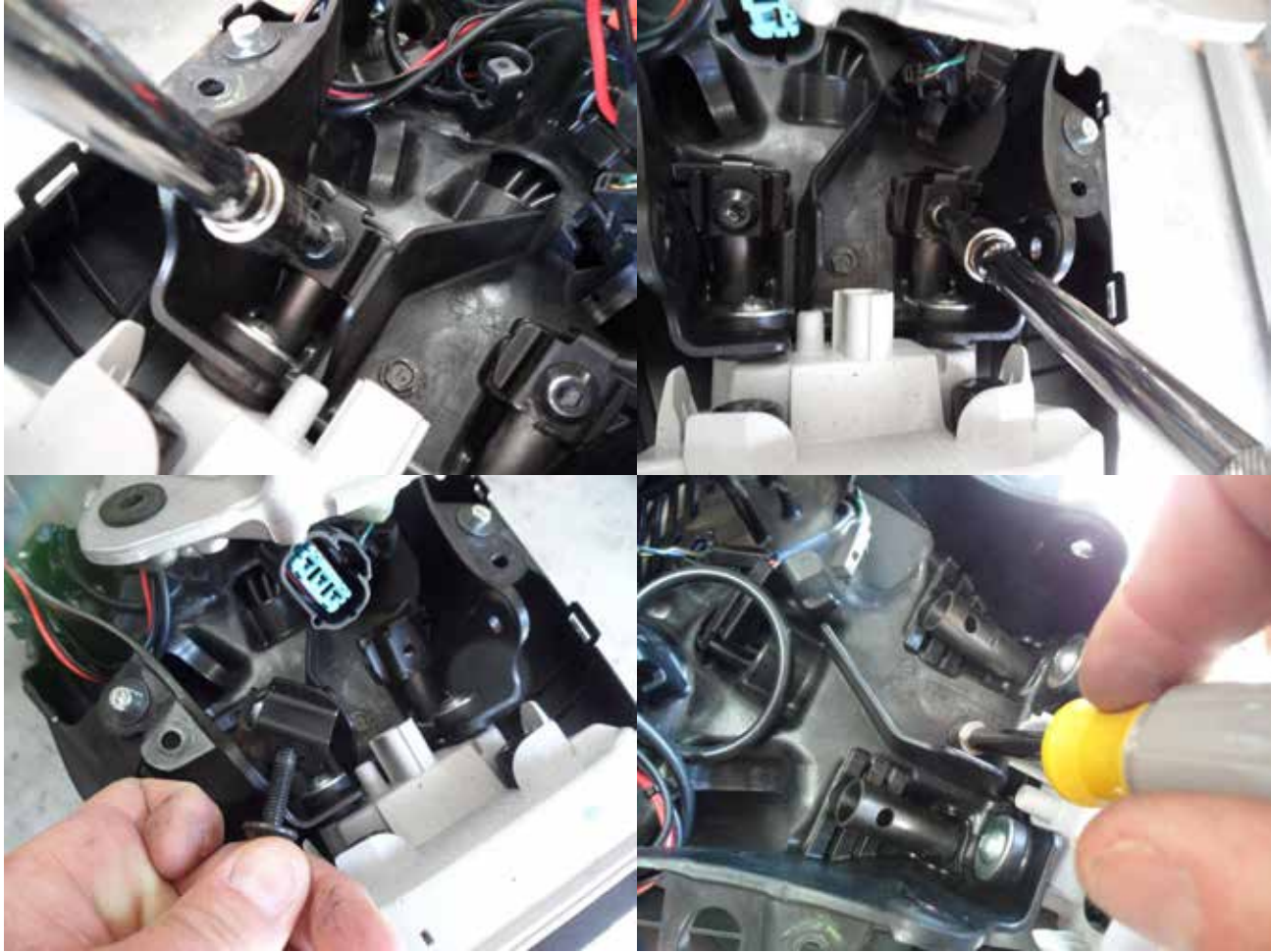

9. Remove smaller side panels attached to storage compartment. Note: There are nuts so you will need an additional wrench to remove.







10. With the rear fender loosened and electronics unplugged gently pull the rear OEM fender out.



11. Install your DMP Fender Eliminator Kit. **NOTE: BUTTON HEADS MUST FACE UP WITH NO WASHERS!!!** (Towards rider) There is not enough clearance between the storage compartment and under tail to use locknuts in this location. All washers go under locknuts. Make sure that the DMP Fender Eliminator kit covers the two existing holes before tightening.



12. To complete the install repeat steps 9-3.