



Yamaha FZ1 Fender Eliminator Kit P/N: 680-6800

Kit Contents

Part Number	Description	Quantity	Part Number	Description	Quantity
99-FE-680-6800	2 pc. Fender Kit	1	99-Wash6x15	6x15mm Washer	2
99-HB-8x30	8x30 Bolt	4	99-Wash6x12	6x12mm Washer	2
99-LN-8	8MM Lock Nuts	4	99-HB-6x12	6x12 Bolt	2
99-LN-6	6MM Lock Nuts	2	Rubber Grom	.562 x 1.00	5
99-Wash8	8MM Washer	8			

Carefully read instructions in their entirety before the installing the part.

Professional installation is recommended. Always use proper safety measures during the installation of this product. Do not try to install this product without proper tools, **safety goggles, and gloves**. The motorcycle must be in a fixed, secure position before the installation process begins. DMP is not responsible for any part of your motorcycle for any reason. Precisely measure location of cut and if in doubt at any point please call us at (949) 453-9111 before the installation process has begun

Note: To complete your installation we recommend using DMP Marker Lights and DMP OEM Type Wire Harness, which are available from your local DMP dealer or www.moto911.com.

1. Remove front and rear set. The front seat has a latch located directly under the seat. It can be accessed through the tail section.



2. Un bolt the four bolts that are holding the OEM fender in place.



3. Remove the body rivets located from underneath the tail section.

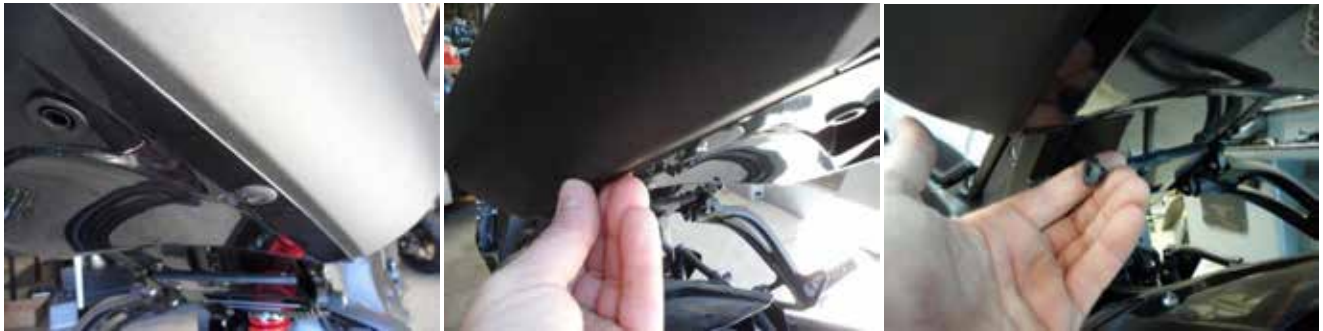

4. Unplug the brake light.



5. Remove the wire covers and unplug the turn signal and plate light connections. Make sure you identify and mark off the left and right turn signals as well as the plate light positive and negative.





6. In order to remove the OEM fender you will need to remove the entire tail section. Follow these pictures in order. Before removing the tail section make sure all bolts and rivets are removed.



7. Remove the mud guard from the fender.



8. Add the 5 rubber grommets to the fender as shown below.



9. Remount the entire tail section and fender following step 6 in reverse. Make sure the fender rivets are put in place and the tail light is plugged in.



10. Loosely mount the DMP fender kit using the four 8x1.25x30 mm bolts, eight 8mm washers and four 8mm lock nuts. Once the plate is loosely mounted, tighten the plate caddy corner until it's tight. (remaining hardware is for mounting the license plate)

11. Install turn signals, plate light and seats.



Note: Following steps are for DMP Marker Light and Plate Light installation. Pictures are for examples only.

12. Mount the DMP turn signals (900-0070) to the plate. Feed the turn signal wires through the center hole of the DMP fender eliminator. Plug the DMP wire extenders (900-0124/900-0125) in (make sure the wire coloring matches). Plug the OEM connectors (900-0123) into the stock turn signal connectors. Plug the proper marker light (left or right) into the previously identified connections (Yellow wire is positive, black is negative).



13. Mount your license plate using the two DMP plate lights (900-2042) and hardware. Feed the wires through the center hole of the DMP fender eliminator. We prefer to use the stock plate light connector and wires. Cut the OEM plate light wires to length one at a time. Crimp the butt connectors supplied and pull on each wire to make sure there is a solid connection.