



P/N: 670-4510, 675-4510  
 Fender Eliminator Kit  
 MADE IN THE USA!

Kit Contents

Part Number	Description	Quantity	Part Number	Description	QTY
99-FE-670-4510-LP	Fender Bracket License Plate	1	6-LN-6	6x1 Lock Nut	6
99-FE-670-4510-BP	Fender Bracket Base Plate	1			
99-Wash6x15	6x15mm Washer	10			
99-HB-6x20	6x20 Bolt	4			
99-Wash6x12	6x12mm	2			
99-HB-6x12	6x12 BH Bolt	2			

Note: Make sure bike is turned off during installation. It is highly recommended that the DMP fender Eliminator is installed by a certified technician. DMP is not responsible for any part of your motorcycle for any reason. If in any doubt please call us during installation.

1. Remove rider and passenger seat.
2. Remove left and right tail section body cowls.



3. Disconnect OEM turn signals and plate light. Loosen fasteners that hold the OEM rear fender and remove.



4. Mount DMP Fender Eliminator Kit using 6 X 20 (4) button heads, 6 X 15 (8) washers and 6 X 1 (4) Locknuts.

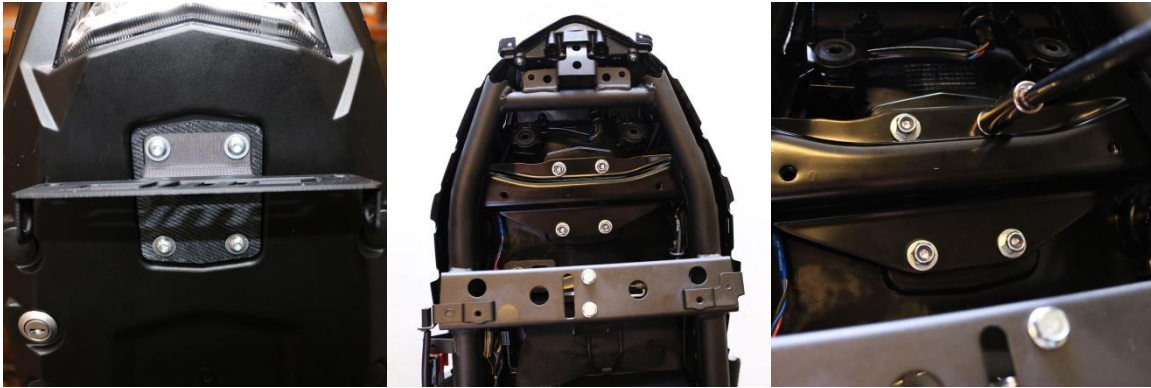

5. Reinstall base fender screws and reinstall side tail section body cowls and seats.

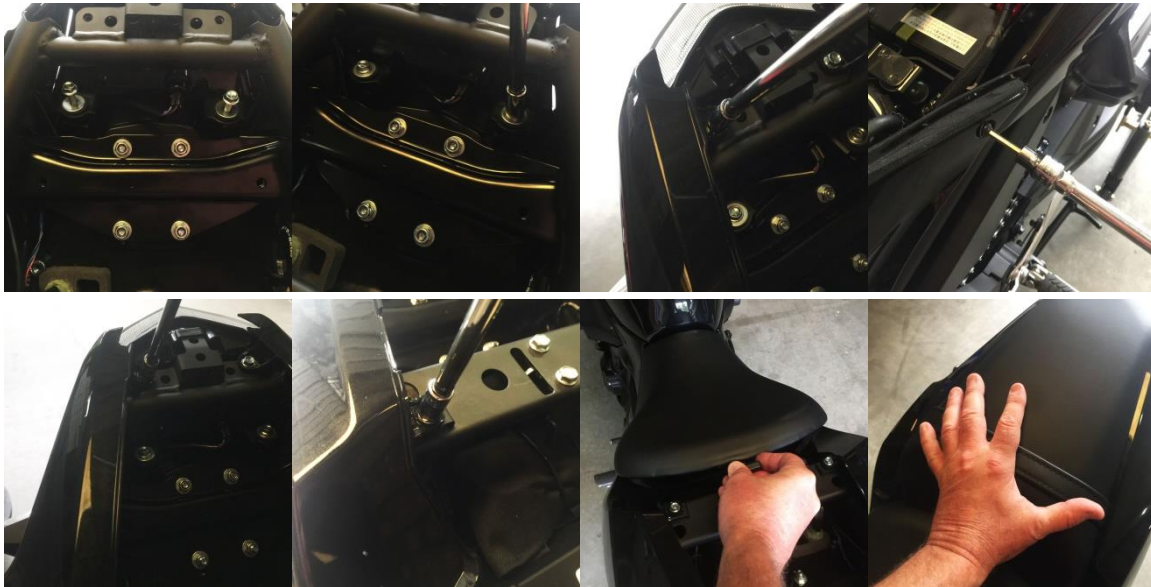

6. Install and wire turn signal and plate lights (OEM turn signals will not work we recommend DMP 10MM marker lights OR any 10MM base stock signals and plate lights).

Steps 7-11 are for part number 675-4510 or DMP marker lights and plate lights install.

7. Mount the DMP turn signals (900-0070) to the plate. Feed the turn signal wires through the center hole of the DMP fender eliminator. Plug the turn signal wires into the DMP wire extenders (900-0124). Route the wires the same way they were routed prior to removal (take photos during the removal process).
8. Plug the DMP OEM connectors (900-0121) into the stock turn signal connectors located on the bike. Connect the turn signal wires to the previously identified (in step 2) wire harness (Yellow wire is positive, black is the negative).

9. You will need to cut and splice the plate wires. We recommend using the OEM wire harness that was removed with the stock fender. From the plastic connectors (on the OEM Fender), cut as much slack as possible (cut as close to the plate light as possible).
10. Mount your license plate using the two supplied DMP plate lights (900-2042) and hardware. Feed the wires through the center hole of the DMP fender eliminator. Plug the OEM plastic plate light connector into place. Tape the head of one wire off using electrical tape. **MAKE SURE THE OTHER WIRE IS NOT TOUCHING ANYTHING THAT WILL GROUND IT OUT OR YOU WILL BLOW A FUSE.** Turn the bike on, once the bike is on the running light positive lead will now be hot. Using a voltage meter, test the voltage of the wire. Your purpose is to identify the positive lead. Once the positive lead has been identified, turn the bike off. Proceed to cut, strip and splice the wires with the supplied connectors (White are the positive leads and Black are the negative).
11. Double check all your connections. Start the bike and double check to make sure all lights are functioning properly.

670-4510



675-4510

